

SER-300-GVx

Multiple Valve Desktop Dispensing System

The SER-300-GVx system is designed with 2 to 4 valves that utilize GLUDITEC's advanced valve technology, which can handle high-viscosity and high-pressure applications, allowing for the dispensing of silicone with viscosities reaching up to 100,000 cps. Its adaptable working area is compatible with the SER desktop robot series, making it suitable for a variety of applications to enhance productivity. The system includes three standard glue feeder options: a cartridge featuring a level sensor, a cartridge equipped with an integrated piston (which isolates glue from air and moisture), and the GLUDITEC precision pump. This configuration provides exceptional flexibility and efficiency for high-volume production settings.



SER-300-GV2

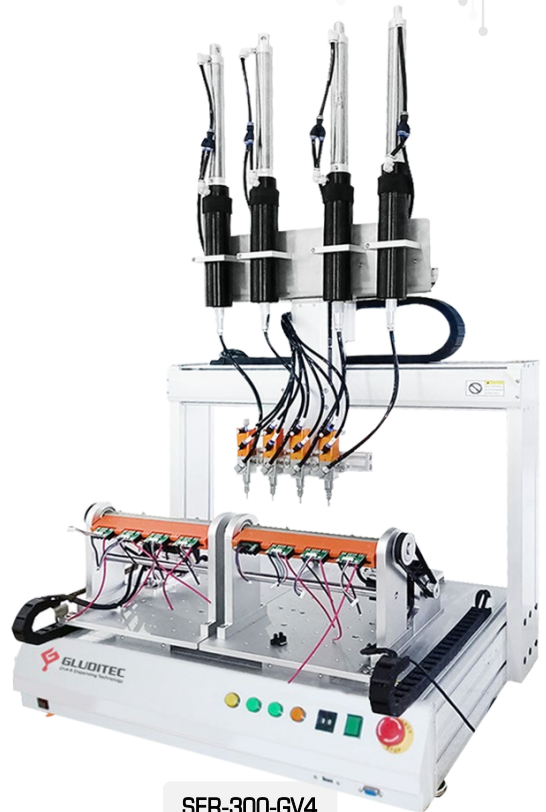

SER-300-GV4

FEATURES

- Number of valve: 2~4 pcs
- Can handle different package size of silicone adhesive from 85g to 330g.
- Dispensing area from 200x200x100 mm to 600x500x100 mm (customizable to be bigger)
- Dot, Lines, Arc etc. and 3D dispensing path is available.
- 100 programs, 4000 points per program.
- A hand-held Teach Pendant is provided for simple and intuitive programming functions.
- Apply adhesives, cyanoacrylates, silicone, RTV, anaerobic resin, epoxy, UV cure formulations and many more fluids.
- Windows SRE software is available for CAD file input (optional).

SER-300-GVx

Multiple Valve Desktop Dispensing System

DESKTOP ROBOT MAIN SPECIFICATIONS

Model	SER-200	SER-300	SER-400	SER-500
Working range (X/ Y/ Z) mm	200 x 200 x 50	300 x 300 x 100	400 x 400 x 100	500 x 500 x 100
Max. load Y/ Z Axis	5kg/ 3kg	11kg/ 6kg		
Speed X & Y/ Z (mm/sec)	500/350	800/350		
Repetitive Positioning Accuracy	±0.02mm/axis			
Program Capacity	Min. 100 group, 4000 points/group			
Data Storage Type	CF Card			
Byte	32 bit			
Program Display	LCD			
Motor System	Micro stepping motor			
Mode of transmission	Synchronous belt	X/Y Axis synchronous belt, Z Axis precision ball screw		
Interpolation Function	3 axis			
Teaching Method	Teach Pendant			
I/O Signals Port	8 Inputs/ 8 Outputs			
External Control Interface	RS232			
Power Supply	AC100 - 230V 300W			
Working Temperature	10 ~ 40°C			
Working Relative Humidity	20 ~ 90% no condensation			
Dimension (L x W x H) mm	385 x 380 x 500	485 x 505 x 610	585 x 610 x 610	785 x 700 x 610
Total weight	23kg	34kg	41kg	56kg

SER-300-300

Desktop Dispensing System for 300ml Cartridge Silicone Adhesive

LIQUID CONTROL

Feeding from various glue package size (Standard Option)



- Different Cartridge Size Holder
- Level Sensor
- Jig



PN	Total Length	Inner Diameter	Outer Diameter
aG-CHD-60	175mm	43mm	79mm
aG-CHD-80	224mm	44mm	50mm
aG-CHD-120	300mm	44mm	50mm
aG-CHD-200	350mm	69mm	77mm
aG-CHD-300	362mm	70mm	79mm

Advanced Options



330g Piston Pump



330g Screw Pump

SER-300-300

Desktop Dispensing System for 300ml Cartridge Silicone Adhesive

LIQUID CONTROL

GV-310 Dispensing Valve

GV-310 dispensing valve features an innovative upward closing mechanism that allows for the simultaneous suction and breaking of glue when dispensing stops. This design minimizes residual glue on the needle head, preventing issues like leakage and wire drawing during dispensing. The valve body is made of anodized aluminum alloy, with a sealing material made of the latest tetrafluoro material. Additionally, all parts that come into contact with the adhesive are made of corrosion-resistant materials.

- Ideal for thick and sticky adhesives like grease, silicone gel, epoxy resin, yellow glue, and solder paste. Compatible with various needle types and pressure tanks.
- Can be integrated with multiple dispensing valves on an automated system to significantly boost productivity, cut down on labor time, and minimize material usage.



Properties	Value
Size	35 x 35 x 160 mm
Weight	580g
Viscosity range	1,000 ~ 100,000 cps
Maximum number of cycles	300 times/min
Input Air Pressure	<10kg
Inlet size	1/4" ntp (f)
Inner diameter of rubber outlet	2.5mm
Minimum output volume	0.01ml
Material of driving part	Stainless Steel
Material of fluid port	Stainless Steel

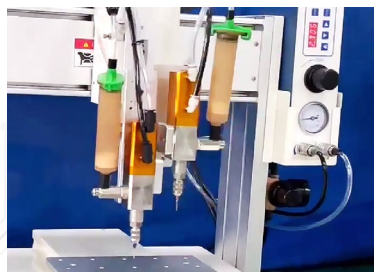
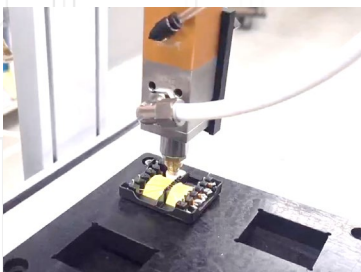
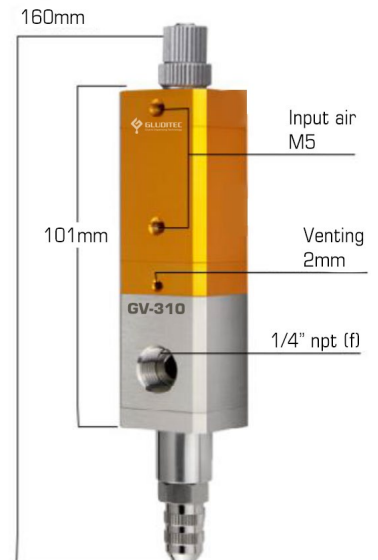

SER-300-300

Desktop Dispensing System for 300ml Cartridge Silicone Adhesive

LIQUID CONTROL

GV-480 Dispensing Valve

GV-480 is a high-pressure dispensing valve designed to dispense high-viscosity fluids such as silicones, RTVs, sealants, pastes, and greases. GV-480 high-pressure valve provides a snap-release shut-off after dispensing, creating a such-back effect that prevents any dripping.

- Adjustable back suction, clean broken glue
- Head and tail glue volume is controllable
- All stainless steel structure, strong and durable
- Dual air path design, quick break
- Simple Maintenance



Properties	Value
Size	34 x 34 x 151.8 mm
Weight	880g
Viscosity range	10,000 ~ 1,000,000 cps
Quantity of material per min	5L/min
Maximum number of cycles	400 times/min
Min. driving pressure	70 psi
Max. driving pressure	3000 psi
Material of driving part	Stainless Steel
Material of fluid port	Stainless Steel
Material of firing pin	Cemented carbide

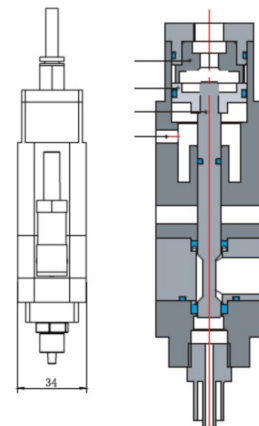
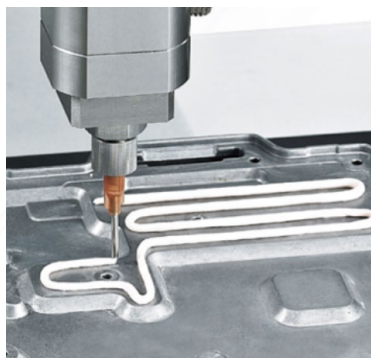
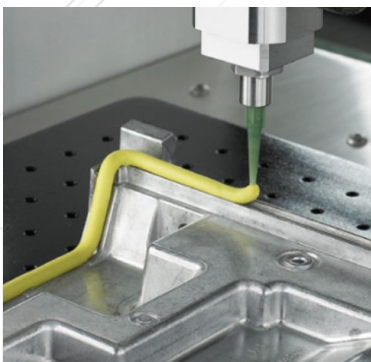
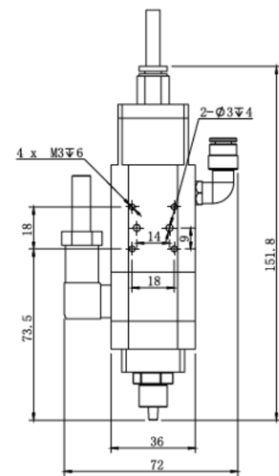

SER-300-300

Desktop Dispensing System for 300ml Cartridge Silicone Adhesive

LIQUID CONTROL

GC-832V Valve Controller

GC-832V controller is a fast, convenient way to adjust valve open time in increments as small as 0.001 seconds, right at the dispensing station. The result is exceptional process control without time-consuming programming or mechanical adjustments that require the production line to be shut down.

- Microprocessor - based control
- Time digital display from 0.001~99.99
- Cycle: 0.05%
- Unique TEACH function
- Memory for time recorder



Properties	Value
Dimension	215 x 225 x 90mm
Weight	1.87kg
Air input	0.5 ~ 0.9 bar
Air output	0.01 ~ 0.8 bar
Repeat Tolerance	±0.1%
Min. volume	0.005ml
Speed	>600 cycles/min
Dispense time	0.001 ~ 99.99 sec +/-0.1%
Voltage	110V/220V±10% 50Hz
Power Consumption	< 15W

GSP-S

Mini SINGLE PROGRESSIVE CAVITY PUMP

GLUDITEC GSP precision of progressive cavity pumps is a result of their positive displacement action, precise screw geometry, variable speed control, linear flow characteristics, and low pulsation, making them well-suited for applications that demand accurate and consistent fluid dispensing.

Model	ml/rev	Speed (mL/min)	Inlet	Net weight (g)
GSP-030S	0.003mL	0.03~ 0.36	1/8"	350
GSP-100S	0.01mL	0.1~1.2	1/8"	350
GSP-600S	0.06mL	0.6~7.2	1/8"	400
GSP-2000S	0.203mL	2~24	1/8"	1.3



Drawing

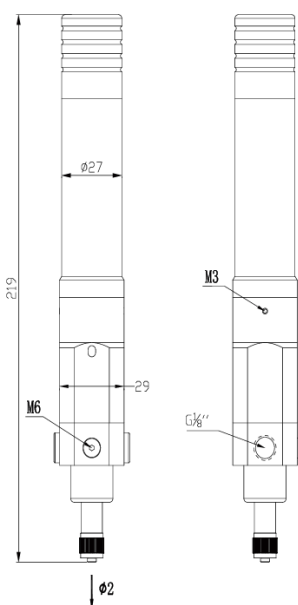

GSP-030S & GSP-100S

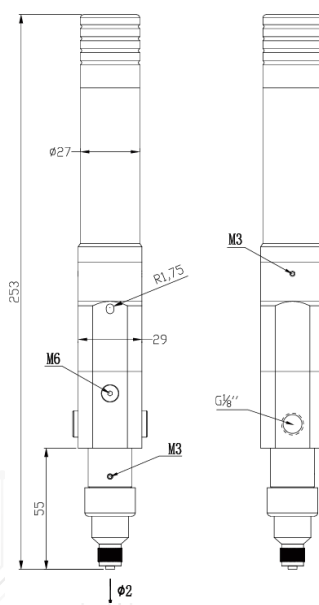

GSP-600S

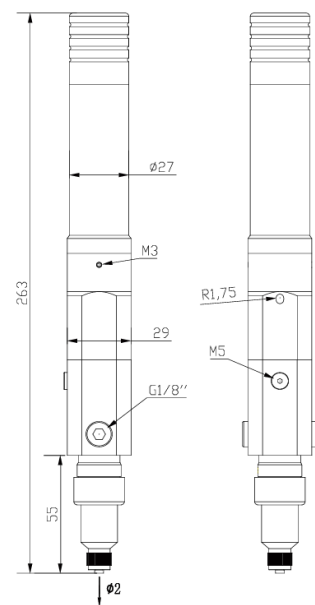

GSP-2000S

GCP Controller

SINGLE PROGRESSIVE CAVITY PUMP CONTROLLER

Properties	GCP-1000	GCP-2000	Non-standard customization
Dimensions (WxDxH)	250 x 220 x 125 mm	250 x 220 x 125 mm	<p>In order to adapt to the progressive cavity pump in different working conditions, GCP controller can be customized. For example: 1 controller for 4 pumps/ 8 pumps or even 16 pumps</p>
Weight	3.4kg	3.6kg	
Power	AC110 ~ 250V, 50/60Hz	AC110 ~ 250V, 50/60Hz	
Screen	4.3" Touch Screen	4.3" Touch Screen	
Number of controlled pump	1	2	
Control Signal	Switching semaphore	Switching semaphore	
Ambient Temperature	10 ~ 40 °C	10 ~ 40 °C	



GCP-1000



GCP-2000

